

SAFETY VALVE

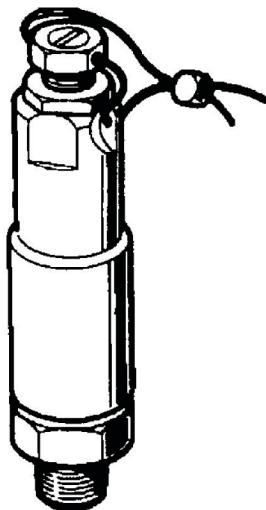

FEATURES:

- Brass and stainless steel construction
- Fully adjustable
- Protects systems components from over-pressure conditions

SPECIFICATIONS

Part Number:	ZKS3
Volume	2.6 - 26.4 GPM
Pressure	0-10,150 PSI
Inlet Port	1/2-14 BSPP - M
Discharge Port	Discharges to atmosphere
Maximum Fluid Temperature	284° F
Weight	2.0 Lbs.
Dimensions	Ø1.6 x 5.7 in.

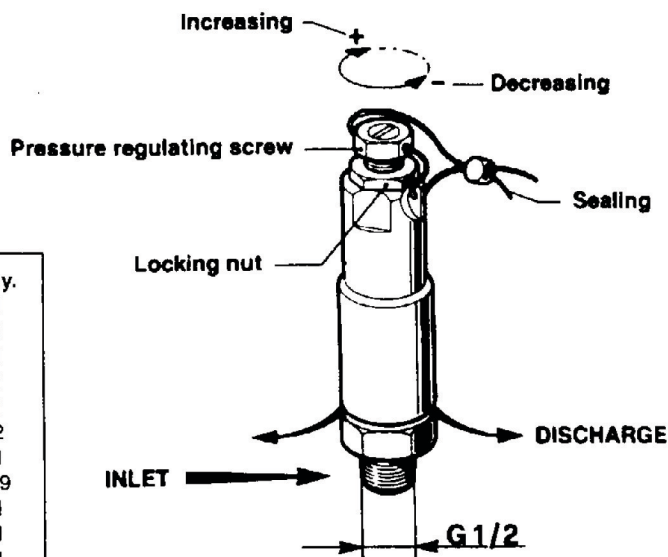
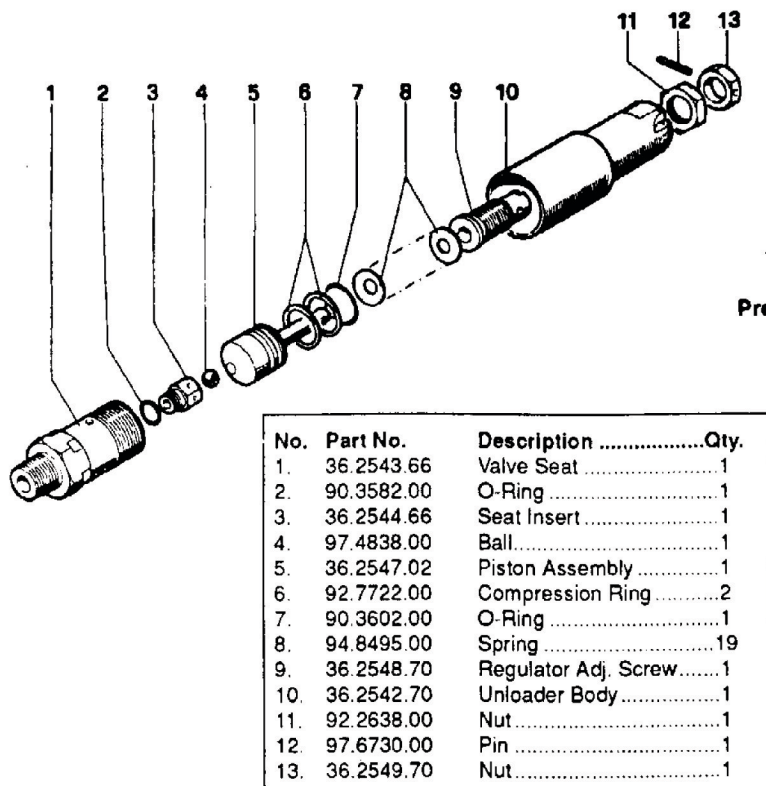

WARRANTY

General Pump accessories are warranted by the manufacturer to be free from defects in material and workmanship. Period of warranty shall be 90 days from date product is received by original buyer. Liability of manufacturer under the foregoing warranty is limited to **repair or replacement** at the option of manufacturer of that product which according to the manufacturer's investigation was deemed defective at time of shipment. Damage resulting from neglect, abuse, tampering or misapplication voids this warranty. This warranty is in lieu of all other warranties, expressed or implied, including any warranty of merchantability and/or any and all other obligations or liabilities on the part of the manufacturer.

GENERAL PUMP

1174 NORTHLAND DRIVE • MENDOTA HEIGHTS, MN 55120 • PHONE: (651)686-2199 • FAX: (800)535-1745
email: sales@gpcompanies.com • www.generalpump.co,

Ref 300564 Rev. A
06-05

